



Westside Library Project  
Initial Design Concepts  
May 1, 2023

All designs and images are subject to change  
and property of  
OPN Architects

For more information on the Westside Library Project,  
visit [CRLibrary.org/locations-hours/westside](https://crlibrary.org/locations-hours/westside).

# SITE PLAN

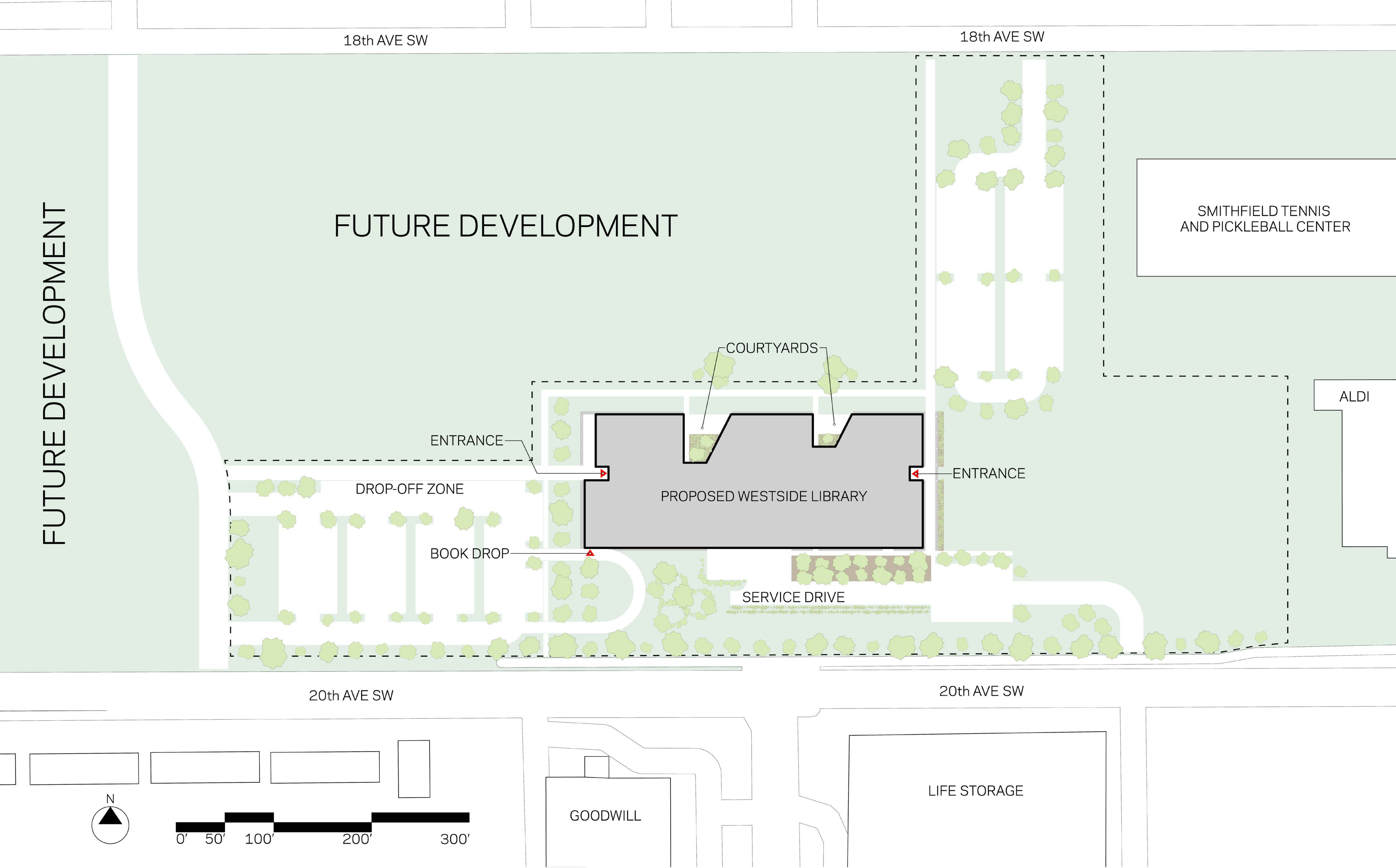



# FLOOR PLAN DIAGRAM

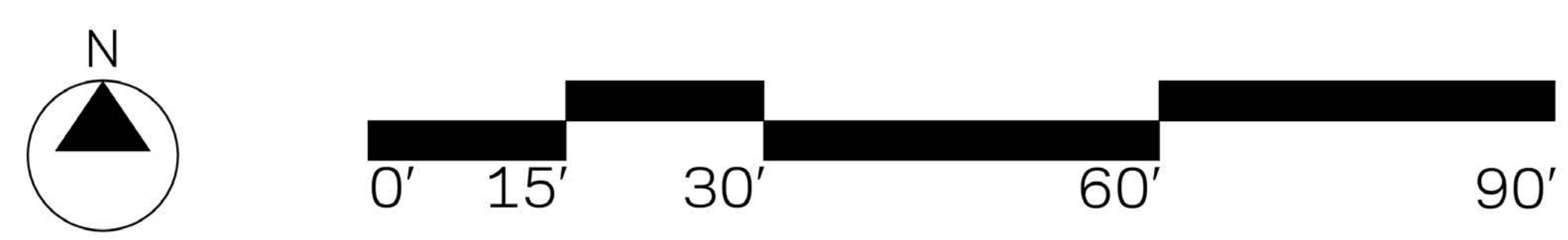

- COMMUNITY / GATHERING
- COLLECTION / PUBLIC AREA
- BACK OF HOUSE / SUPPORT





OPN  
ARCHITECTS

# COMMUNITY HUB

Additional 12,385 square feet of public space.

PUBLIC SPACE NOW		PUBLIC SPACE PROPOSED
<b>15,045 SF</b>	<b>+12,385 SF</b> 	<b>27,430 SF</b>

## COMMUNITY ENGAGEMENT SPACES

- 12 study rooms
- 1 dedicated children's program room
- 1 large conference room
- conference center with prefunction spaces, dedicated kitchenette, direct entry and adjacent parking
- 2 outdoor reading/gathering spaces

## TECHNOLOGY

- separate computer stations for all age groups
  - children's
  - young adults
  - adults
- meeting/study room reservation system
- drive up & walk up automated book return
- slider doors for easy accessibility
- drive-up service window for easy pick-up



OPN  
ARCHITECTS





# EARLY CHILDHOOD LITERACY

## CHILDREN'S COLLECTION

- more space for children's learning
- zones for creative play, technology use and motor skill development
- spaces for caregivers and children to read together
- collection space that can be more easily browsed by younger patrons
- furniture sized for younger patrons
- a new program room/classroom dedicated to story time and youth programming
- a mother's room and dedicated family restroom located near the children's wing
- preservation and reuse of original children's area relief sculpture





# EXTERIOR PERSPECTIVE - WEST ENTRANCE





# INTERIOR PERSPECTIVE - LOBBY FROM WEST ENTRANCE

